



Please dispose of packaging for the product in a responsible manner. It is suitable for recycling. Help to protect the environment, take the packaging to the local amenity tip and place into the appropriate recycling bin.



Never dispose of electrical equipment or batteries in with your domestic waste. If your supplier offers a disposal facility please use it or alternatively use a recognised re-cycling agent. This will allow the recycling of raw materials and help protect the environment.



# 01943 6"x 10" Belt Disc Sander



**FOR HELP OR ADVISE ON THIS PRODUCT PLEASE CONTACT YOUR DISTRIBUTOR,  
OR SIP DIRECTLY ON:**

**TEL: 01509500400**

**EMAIL: [sales@sip-group.com](mailto:sales@sip-group.com) or [technical@sip-group.com](mailto:technical@sip-group.com)**

**[www.sip-group.com](http://www.sip-group.com)**

**Please read and fully understand the instructions in  
this manual before operation. Keep this manual  
safe for future reference**

Declaration of Conformity

We

SIP (Industrial Products) Ltd  
Gelders Hall Road  
Shepshed  
Loughborough  
Leicestershire  
LE12 9NH  
England

As the manufacturer's authorised representative within the EC  
declare that the

6"x 10" Belt / Disc Sander - SIP Pt. No. 01943

**Conforms to the requirements of the following directive(s), as indicated.**

|             |                       |
|-------------|-----------------------|
| 2006/95/EC  | Low Voltage Directive |
| 2006/42/EC  | Machinery Directive   |
| 2004/108/EC | EMC Directive         |
| 2002/95/EC  | ROHS Directive        |

**And the following harmonised standard(s)**

EN ISO 12100-2/A1:2009  
EN 61029-1:2009  
EN 55014-1:2006  
EN 55014-2/A1:2008  
EN 61000-3-2:2006  
EN 61000-3-3:2008

Signed:  .....

Mr P. Ippaso - Director - SIP (Industrial Products) Ltd  
Date: 21/05/2010.



| <b>Page No.</b> | <b>Description</b>                    |
|-----------------|---------------------------------------|
| <b>4.</b>       | Safety instructions                   |
| <b>6.</b>       | Electrical connections                |
| <b>8.</b>       | Technical specifications              |
| <b>9.</b>       | Getting to know your belt disc sander |
| <b>10.</b>      | Assembly instructions                 |
| <b>14.</b>      | Operating instructions                |
| <b>16.</b>      | Care and maintenance                  |
| <b>18.</b>      | Exploded diagram                      |
| <b>19.</b>      | Parts list                            |
| <b>23.</b>      | Declaration on conformity             |

## SAFETY INSTRUCTIONS

**IMPORTANT:** Please read the following instructions carefully, **failure to do so could lead to serious personal injury and / or damage to the Belt Disc Sander.**

When using your belt disc sander, basic safety precautions should always be followed to reduce the risk of fire, electric shock, personal injury and / or damage to the belt disc sander. Read all these instructions before operating the belt disc sander and save this user manual for future reference.

**SIP** recommends that this belt disc sander should **not** be modified or used for any application other than that for which it was designed. If you are unsure of its relative applications do not hesitate to contact us and we will be more than happy to advise you.

**KNOW YOUR BELT DISC SANDER:** Read and understand the owner's manual and labels affixed to the belt disc sander. Learn its applications and limitations, as well as the potential hazards specific to it.

**DO NOT USE THE BELT DISC SANDER IN DANGEROUS ENVIRONMENTS:** Do not use your belt disc sander in damp or wet locations, or expose it to rain. Always provide adequate space around the belt disc sander.

**KEEP CHILDREN AND UNTRAINED PERSONNEL AWAY FROM THE WORK AREA:** All visitors should be kept at a safe distance from the work area.

**STAY ALERT:** Always watch what you are doing and use common sense.

**DISCONNECT THE BELT DISC SANDER FROM THE MAINS SUPPLY:** When not in use.

**DO NOT ABUSE THE MAINS LEAD:** Never pull the mains lead to remove the plug from the mains socket. Keep the mains lead away from heat, oil and sharp edges. If the mains lead is damaged, it must be replaced by the manufacturer or its service agent or a similarly qualified person in order to avoid unwanted hazards.

**HAVE YOUR BELT DISC SANDER REPAIRED BY A QUALIFIED PERSON:** The belt disc sander is in accordance with the relevant safety requirements. Repairs should only be carried out by qualified persons using original spare parts, otherwise this may result in considerable danger to the user.

- **DANGER!** Check that the belt disc sander is in sound condition and good working order. Take immediate action to repair or replace damaged parts.
- **Use recommended parts only** - Unapproved parts may be dangerous and will invalidate the warranty.
- **WARNING!** Only operate on a level and stable surface.
- **WARNING!** Do not allow untrained persons to operate the machine and do not operate the machine without all covers etc. correctly fitted.
- **WARNING! RISK OF ELECTRIC SHOCK.** Do not expose the belt disc sander to water spray, rain, dripping water or moisture of any kind.
- Do not move or handle the machine when it is running.
- Do not leave the machine unattended when in use. Switch the machine off and unplug from the mains supply before leaving the work area.
- Do not allow children or animals near the belt disc sander, particularly when in use.

## PARTS LIST Continued...

| No. | Description   | SIP Part No. |
|-----|---------------|--------------|
| 79  | Table support | WD02-00083   |
| 80  | Bolt M6 x 20  | WD02-00084   |
| 81  | Baffle plate  | WD02-00085   |

## LEG STAND & MITRE GUIDE PARTS LIST

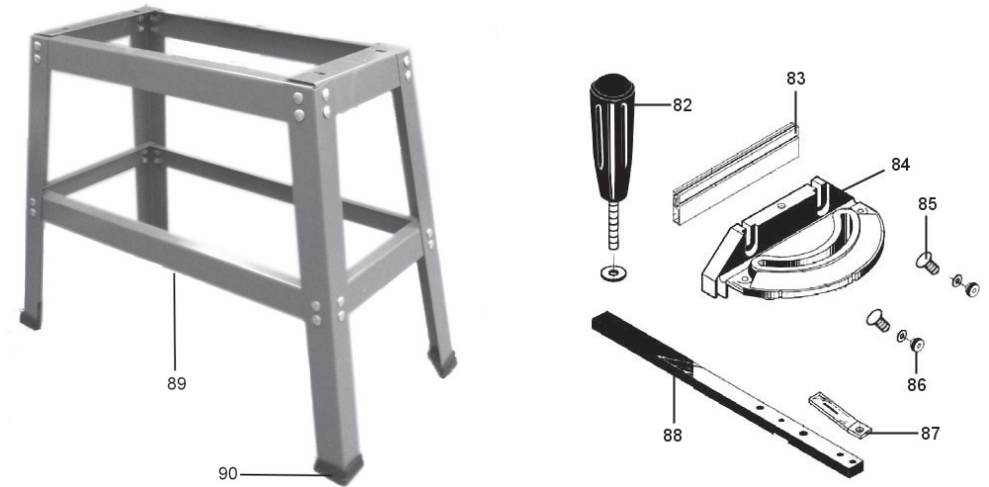

| No. | Description        | SIP Part No. | No. | Description        | SIP Part No. |
|-----|--------------------|--------------|-----|--------------------|--------------|
| 82  | Mitre guide handle | WD02-00086   | 87  | Pointer            | WD02-00091   |
| 83  | Fence              | WD02-00087   | 88  | Guide bar          | WD02-00092   |
| 84  | Mitre guide body   | WD02-00088   | 89  | Leg stand complete | WD02-00093   |
| 85  | Bolt               | WD02-00089   | 90  | Foot               | WD02-00094   |
| 86  | Thumb nut          | WD02-00090   |     |                    |              |

## PARTS LIST Continued...

| No. | Description                  | SIP Part No. |
|-----|------------------------------|--------------|
| 38  | Screw M6 x 16                | WD02-00034   |
| 39  | Main base                    | WD02-00042   |
| 40  | Motor cover                  | WD02-00043   |
| 41  | Sanding belt safety guard    | WD02-00044   |
| 42  | Self tapping screw 4 x 12    | WD02-00045   |
| 43  | Screw M6 x 150               | WD02-00046   |
| 44  | Rubber sleeve                | WD02-00047   |
| 45  | Support stem                 | WD02-00048   |
| 46  | Lock base sander belt        | WD02-00049   |
| 47  | Motor                        | WD02-00050   |
| 48  | Bolt M8 x 16                 | WD02-00051   |
| 49  | Lock washer                  | WD02-00052   |
| 50  | Motor drive pulley           | WD02-00053   |
| 51  | Washer (big)                 | WD02-00054   |
| 52  | Bolt (left) M6 x 12          | WD02-00055   |
| 53  | Belt cover                   | WD02-00056   |
| 54  | Timing belt                  | WD02-00057   |
| 55  | Drive pulley                 | WD02-00058   |
| 56  | Hex socket cap screw M5 x 40 | WD02-00059   |
| 57  | Bearing support              | WD02-00060   |
| 58  | Sander lock plate            | WD02-00061   |
| 59  | Hex socket cap screw M8 x 25 | WD02-00062   |
| 60  | Retaining ring 15 mm         | WD02-00063   |
| 61  | Ball bearing                 | WD02-00064   |
| 62  | Drive shaft                  | WD02-00065   |
| 63  | Screw M5 x 15                | WD02-00066   |
| 64  | Rubber washer                | WD02-00067   |
| 65  | Tension lever                | WD02-00068   |
| 66  | Lever spacer                 | WD02-00069   |
| 67  | Washer                       | WD02-00070   |
| 68  | Index spring                 | WD02-00071   |
| 69  | Rubber bushing               | WD02-00072   |
| 70  | Retaining ring 12 mm         | WD02-00073   |
| 71  | Ball bearing 6201            | WD02-00074   |
| 72  | Idler drum                   | WD02-00075   |
| 73  | Idler shaft                  | WD02-00076   |
| 74  | Drum guide                   | WD02-00077   |
| 75  | Index spring                 | WD02-00078   |
| 76  | Mains Lead                   | WD02-00079   |
| 77  | Table angle Guide            | WD02-00080   |
| 78  | Table frame bracket          | WD02-00081   |

## SAFETY INSTRUCTIONS...cont

- Ensure that the belt disc sander is correctly turned off when not in use and store in a safe, dry area, out of reach of children.
- Do not unplug the belt disc sander to switch it off - always use the on/off switch.
- Keep all combustible materials away from this belt disc sander.
- ALWAYS locate belt disc sander on a stable and level surface.
- ALWAYS keep children and animals away from belt disc sander.
- Never stand on the belt disc sander.
- DO NOT dismantle or tamper with the belt disc sander, as this may be dangerous and will invalidate the warranty.

If a problem with the belt disc sander is experienced, or if the mains lead or plug become damaged, contact your distributor for repair.

The Electricity at Work Act 1989 requires that all portable electrical appliances, if used on business premises, are tested by a qualified electrician, using a Portable Appliance Tester (PAT), at least once a year.

### WARNING: Risk of Electric Shock!

- Use only the electrical power (voltage and frequency) specified on the model plate of the belt disc sander. If in doubt contact the manufacturer.
- Use only a three-prong, grounded outlet and where required.
- ALWAYS unplug the belt disc sander when not in use.

### Safety Symbols Used Throughout This Manual



**Danger / Caution:** Indicates risk of personal injury and/or the possibility of damage.

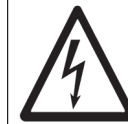

**Warning:** Risk of electrical injury or damage!



**Note:** Supplementary information.

## SAFETY INSTRUCTIONS...cont



When using the sander always ensure the operator as well as those in the area wear eye protection.



Sanding operations will cause dust to become airborne with the potential to be highly toxic; always wear a face mask during these operations, as well as ensuring the area is well ventilated. It is also highly recommended to use a dust collector to reduce airborne particles.



When using this sander, it is advisable to ensure the operator as well as those in the area wear ear protection, particularly during extended periods of use.



**CAUTION:** The warnings and cautions mentioned in this user manual can not cover all possible conditions and situations that may occur. It must be understood by the operator that common sense and caution are factors which cannot be built into this product, but must be applied.

## ELECTRICAL CONNECTION

**WARNING!** It is the responsibility of the owner and the operator to read, understand and comply with the following:

You must check all electrical products, before use, to ensure that they are safe.

You must inspect power cables, plugs, sockets and any other connectors for wear or damage.

You must ensure that the risk of electric shock is minimised by the installation of appropriate safety devices; A residual current circuit Breaker (RCCB) should be incorporated in the main distribution board. We also recommend that a residual current Device (RCD) is used. It is particularly important to use an RCD with portable products that are plugged into a supply which is not protected by an RCCB. If in any doubt consult a qualified electrician.

### Connecting to the power supply:

This SIP sander is fitted with a standard 230v ~ 13 amp type plug. Before using the heater, inspect the mains lead and plug to ensure that neither are damaged. If any damage is visible have the heater inspected / repaired by a suitably qualified person. If it is necessary to replace the plug a heavy duty impact resistant plug would be preferable.

## PARTS LIST

| No. | Description                         | SIP Part No. |
|-----|-------------------------------------|--------------|
| 1   | Sanding belt 152 x 1219 mm 60 grit  | 06870        |
|     | Sanding belt 152 x 1219 mm 80 grit  | 06868        |
|     | Sanding belt 152 x 1219 mm 120 grit | 06270        |
| 2   | Bed                                 | WD02-00004   |
| 3   | Knob                                | WD02-00005   |
| 4   | Washer                              | WD02-00006   |
| 5   | Bolt M4x8                           | WD02-00007   |
| 6   | Nut M6                              | WD02-00008   |
| 7   | Fence                               | WD02-00009   |
| 8   | Fence support                       | WD02-00010   |
| 9   | Lock pin for fence support          | WD02-00011   |
| 10  | Nut M6                              | WD02-00008   |
| 11  | Lock washer 5 mm                    | WD02-00013   |
| 12  | Screw M6 x 10                       | WD02-00014   |
| 13  | Self tapping screw 4x16             | WD02-00015   |
| 14  | Switch housing                      | WD02-00016   |
| 15  | No-volt release switch KJD12        | WD02-00017   |
| 16  | Screw 4 x 16                        | WD02-00015   |
| 17  | Bearing cap                         | WD02-00018   |
| 18  | Sleeve                              | WD02-00019   |
| 19  | Pin                                 | WD02-00020   |
| 20  | Drive drum                          | WD02-00021   |
| 21  | Rear switch housing cover           | WD02-00022   |
| 22  | 10" Sanding disc 60 grit coarse     | 06860        |
|     | 10" Sanding disc 80 grit coarse     | 06861        |
|     | 10" Sanding disc 120 grit medium    | 06862        |
|     | 10" Sanding disc 150 grit fine      | 06864        |
| 23  | Screw M6 x 10                       | WD02-00027   |
| 24  | Sanding disc                        | WD02-00028   |
| 25  | Sanding disc support                | WD02-00029   |
| 26  | Screw M4 x 45                       | WD02-00030   |
| 27  | Sanding disc guard                  | WD02-00031   |
| 28  | Sanding disc cover guard            | WD02-00032   |
| 29  | Hex nut M6                          | WD02-00008   |
| 30  | Bolt M6 x 16                        | WD02-00034   |
| 31  | Table frame bracket                 | WD02-00035   |
| 32  | Table support                       | WD02-00036   |
| 33  | Table                               | WD02-00037   |
| 34  | Dust port                           | WD02-00038   |
| 35  | Self tapping screw 4 x 20           | WD02-00039   |
| 36  | Clamp handle                        | WD02-00040   |
| 37  | Carrying handle                     | WD02-00041   |

## EXPLODED DIAGRAM

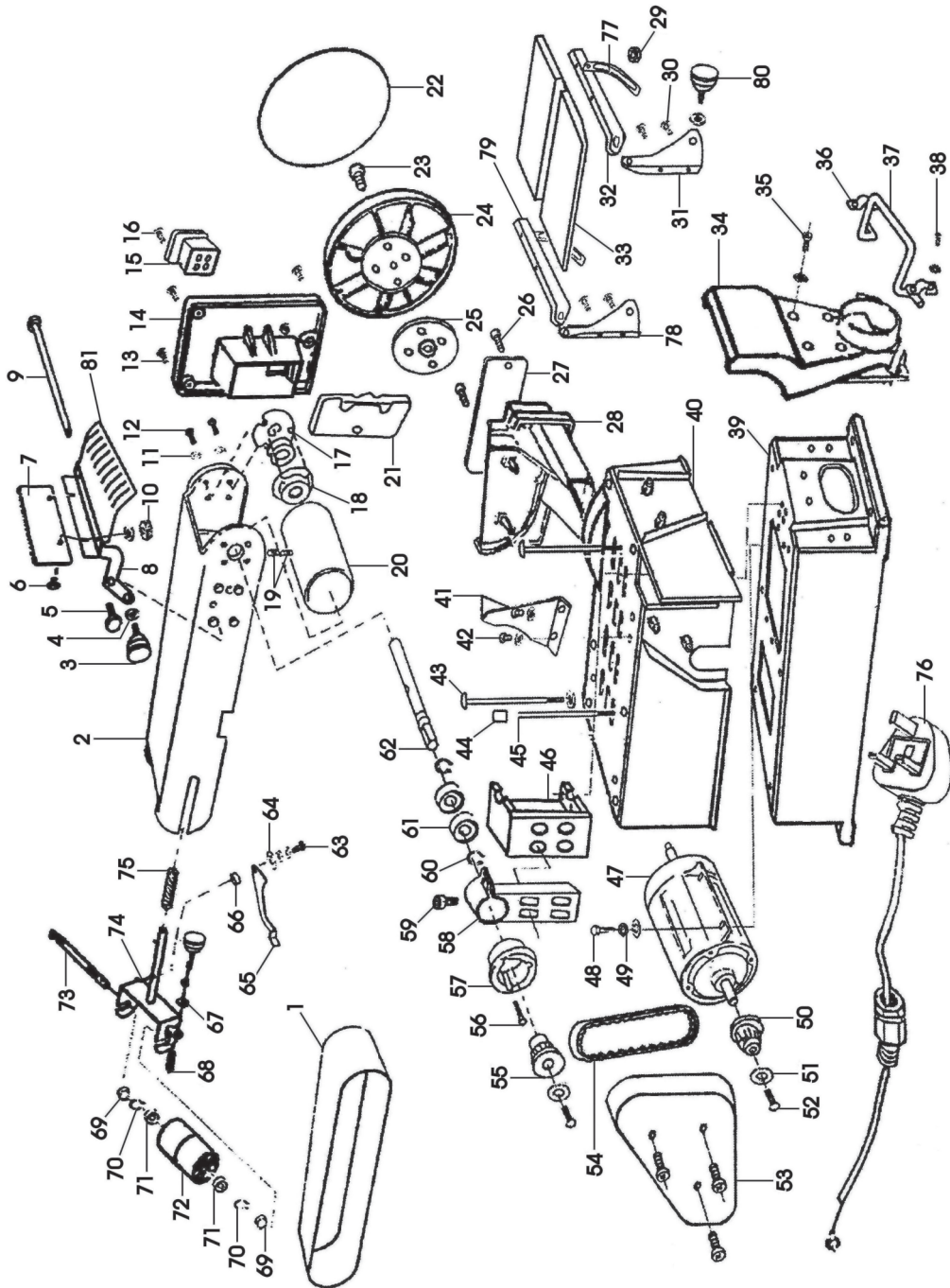

## ELECTRICAL CONNECTION...cont

The wires for the plug are coloured in the following way:

|                |         |
|----------------|---------|
| Yellow / green | Earth   |
| Blue           | Neutral |
| Brown          | Live    |

As the colours of the wires may not correspond with the markings in your plug, proceed as follows: The wire which is coloured blue, must be connected to the terminal marked with N or coloured black. The wire which is coloured brown, must be connected to the terminal, which is marked L or coloured red. The wire which is coloured yellow / green should be connected to the terminal which is coloured the same or marked



Always secure the wires in the plug terminal carefully and tightly. Secure the cable in the cord grip carefully.

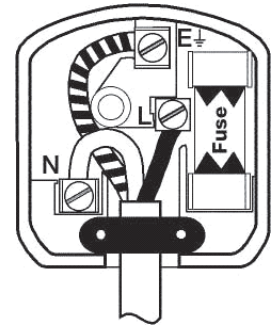

**Warning:** Never connect live or neutral wires to the earth terminal of the plug. Only fit an approved plug with the correct rated fuse (5 amp). If in doubt consult a qualified electrician.



**Note:** Always make sure the mains supply is of the correct voltage and the correct fuse protection is used. In the event of replacing the fuse always replace the fuse with the same value as the original.



**Note:** If an extension lead is required in order to reach the mains supply; ensure that this too is rated for the correct voltage and fuse rating.



**Note:** The cross section of the extension lead should be checked so that it is of sufficient size so as to reduce the chances of voltage drops.

## GUARANTEE

### Guarantee:

This SIP belt disc sander is covered by a 24 month parts and labour warranty covering failure due to manufacturers defects. This does not cover failure due to misuse or operating the machine outside the scope of this manual.

In the unlikely event of warranty claims, contact your distributor as soon as possible. Proof of purchase will be required before any warranty can be honoured.



**Note:** Proof of purchase will be required before any warranty can be honoured.

## TECHNICAL SPECIFICATIONS

|                   |                 |
|-------------------|-----------------|
| <b>Model No.</b>  | 01943           |
| <b>Supply</b>     | 230v ~ 50Hz     |
| <b>Power</b>      | 800 Watts       |
| <b>Belt Speed</b> | 500 M/Min       |
| <b>Disc Speed</b> | 1440 RPM        |
| <b>Disc Size</b>  | 254 MM (10")    |
| <b>Belt Size</b>  | 150 x 1220 MM   |
| <b>Table Size</b> | 318 mm x 206 mm |

## CARE AND MAINTENANCE....cont

Remove the belt cover which is secured by 3 x cross head screws. Using a 12 mm spanner loosen (do not remove) the four bolts shown in diagram.

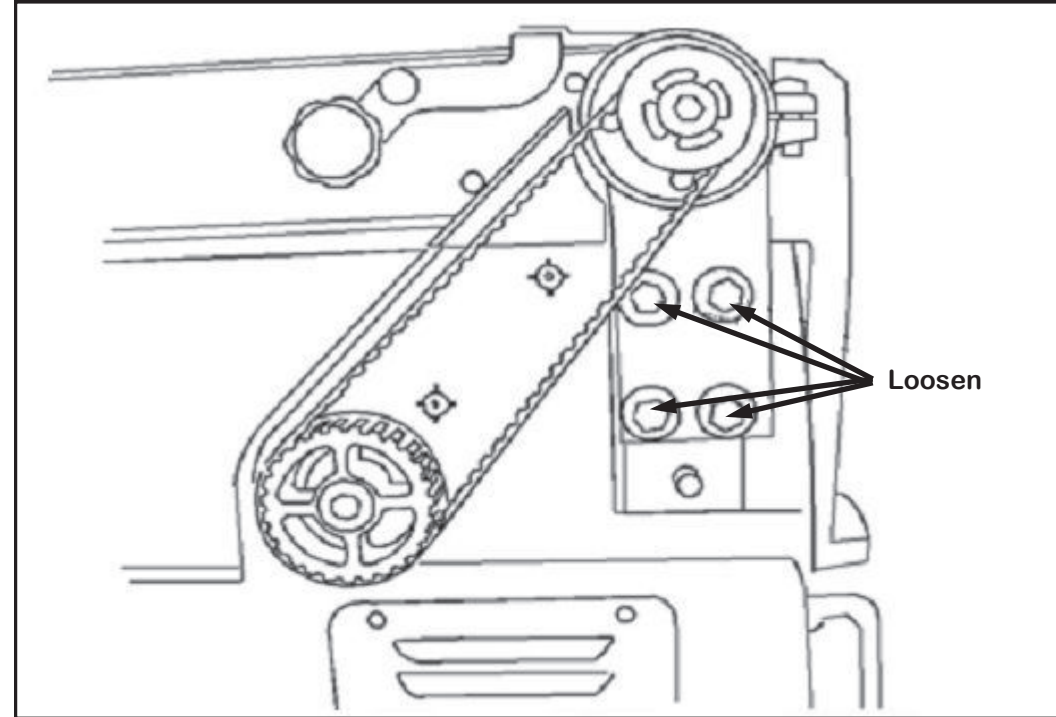

This allows the belt assembly to drop sufficiently to remove the old belt and replace with a new one. Once the new belt is fitted lift the assembly as high as possible and tighten the four bolts up using the 12 mm spanner. Check the belt tension by placing fingers on either side of the belt and squeeze. Correct tension will allow approximately 6 mm deflection in the belt. Replace the belt cover.



## CARE AND MAINTENANCE

### ISOLATE THE MACHINE FROM THE MAINS SUPPLY:

- Slide the belt tensioning lever (item 2 on page 9) to slacken the belt.
- Unscrew the knurled bolt from the side of the belt table and remove.
- Unscrew the two black knobs which hold the rear fence on the belt table, and remove.

The sanding belt can now be removed from the table. Follow this procedure in reverse order to replace with new belt.



Once a new belt has been fitted it is likely that the belt will require tracking to keep the belt running central to the table.

To do this rotate the black knob (whilst the disc sander is running) as indicated in the diagram, turning clockwise or anticlockwise until the belt runs centrally on the table.

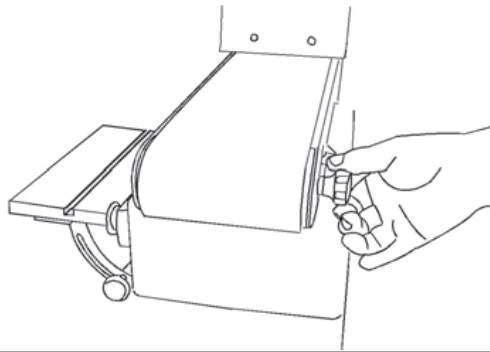

### Replacing The Sanding Disc:

Remove the sanding table as required.  
Remove the two screws securing the lower disc guard.  
Remove the backing from the abrasive disc and align it with the aluminium sanding disc - Press firmly to secure.  
Replace the lower disc guard.  
Replace the sanding table as required.

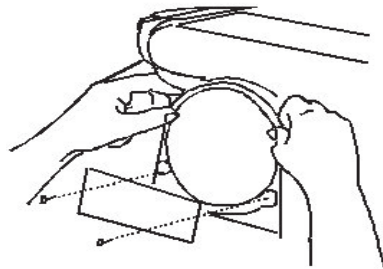

## GETTING TO KNOW YOUR BELT DISC SANDER

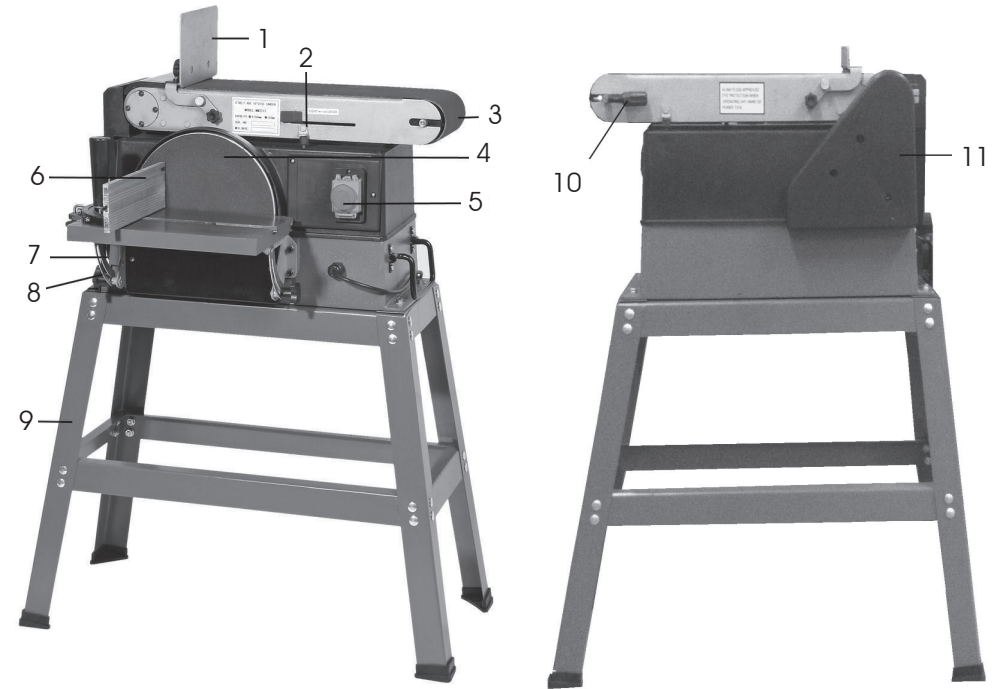

|    |                       |
|----|-----------------------|
| 1  | Fence                 |
| 2  | Belt Tensioning Lever |
| 3  | 6" Sanding Belt       |
| 4  | 10" Sanding Disc      |
| 5  | On / Off (NVR) Switch |
| 6  | Mitre Fence           |
| 7  | Dust Extraction Port  |
| 8  | Table Angle Gauge     |
| 9  | Leg Stand             |
| 10 | Tracking Adjuster     |
| 11 | Drive Belt Guard      |

## ASSEMBLY INSTRUCTIONS

### Leg Stand Parts

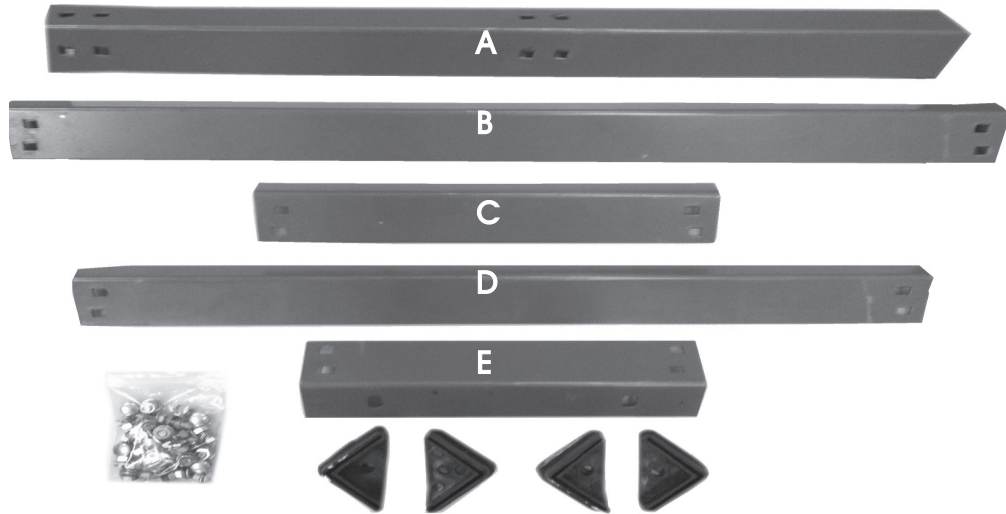

| FIG | DESCRIPTION            | QTY |
|-----|------------------------|-----|
| A   | Leg                    | 4   |
| B   | Lower Support (Length) | 2   |
| C   | Lower Support (width)  | 2   |
| D   | Upper Support (Length) | 2   |
| E   | Upper Support (Width)  | 2   |
| N/A | Rubber Feet            | 4   |
| N/A | Bolt (M8 x 10)         | 32  |
| N/A | Washer (8 mm)          | 32  |
| N/A | Nut (M8)               | 32  |

## OPERATING INSTRUCTIONS...cont

Below diagrams show the belt sander sanding curved edges, When sanding with the idler drum, use very light pressure. If you press too hard, you'll put an unnecessary strain on the sleeve bearings in the idler drum.

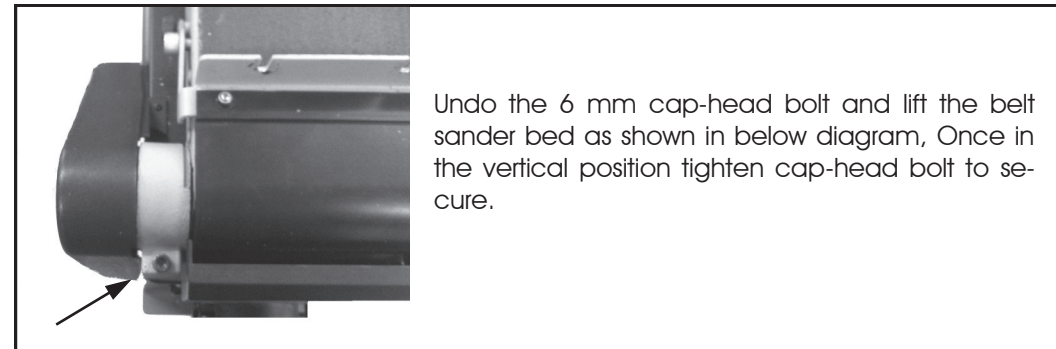
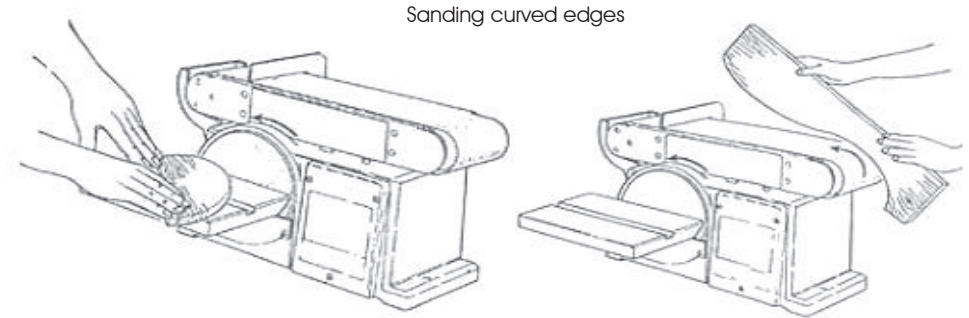

As shown in diagram the belt sander is now in a vertical position, Never leave the machine running in this position when not in attendance .



## ASSEMBLY INSTRUCTIONS...cont

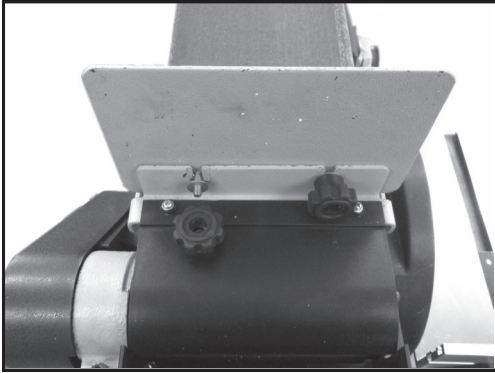

Lastly fit the fence as shown in the picture.

## OPERATING INSTRUCTIONS



**Note:** This belt disc sander is designed only for sanding operations involving wood or wood derived products. It is not suitable for use with any type of metal - your warranty will be void if the sander is used for this purpose.

Surface sanding on sanding belt

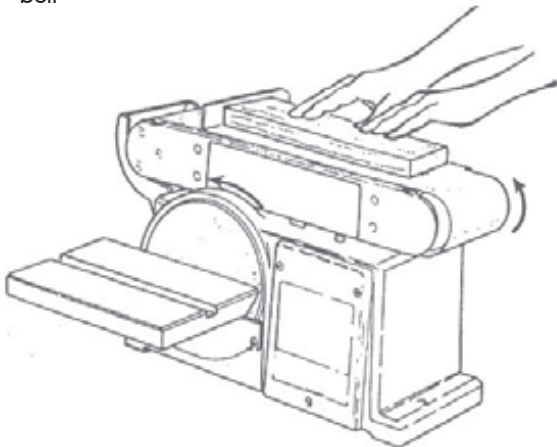

Note when sanding on the belt sander be sure not to apply too much pressure. Always remember this is not suitable for any type of metal as this will void your warranty and damage the machine.

## ASSEMBLY INSTRUCTIONS...cont

### Leg Stand Assembly

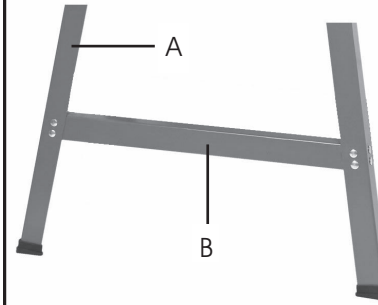

Take upright leg (A) x2 and bolt to lower support (length) (B) x1 using the bolts supplied on both sides until you have a `H` frame as show in below diagram, Now repeat above steps until there are two `H` frames.



**Note:** Do not fully tighten the bolts at this point as some adjustment may be necessary.

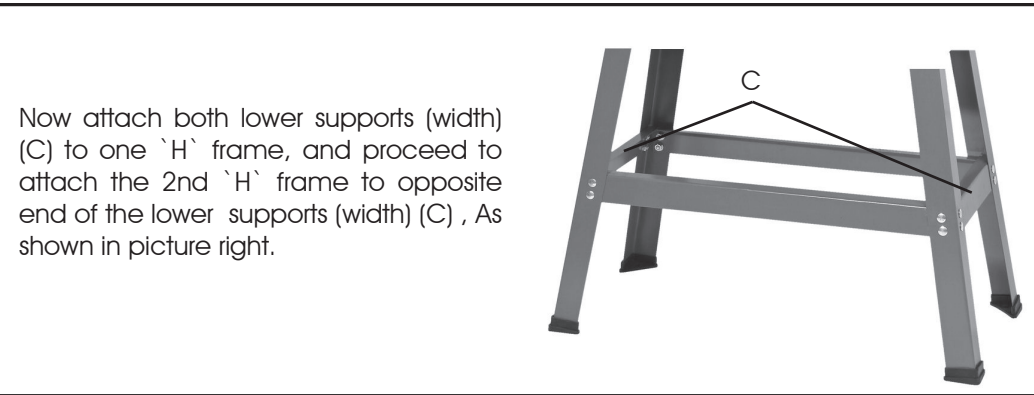

Now attach both lower supports (width) (C) to one `H` frame, and proceed to attach the 2nd `H` frame to opposite end of the lower supports (width) (C) , As shown in picture right.

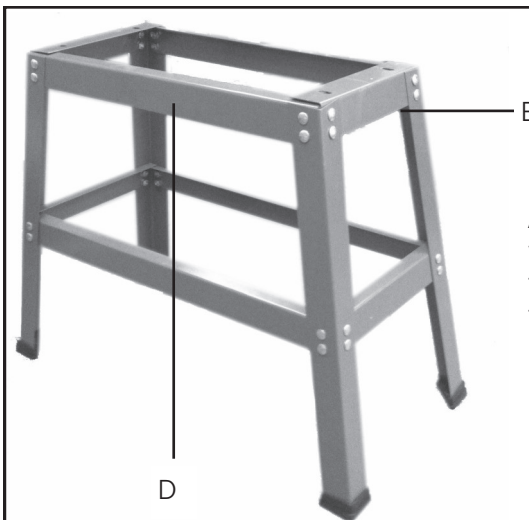

Attach the upper supports (length & width) (D & E) to the frame and complete the leg-set by pressing 4 rubber feet to the bottom of each leg.

## ASSEMBLY INSTRUCTIONS...cont

Fit the belt disc sander to the leg stand using the 4 bolts, nuts and washers supplied, Below diagram is how your belt disc sander should look like.



**Note:** Due to the weight of the sander; at least 2 persons are required to lift it safely.

### Fitting The Accessories

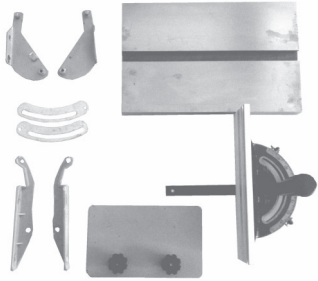

Parts:  
2x Frame brackets  
2x Angle guide  
2x Table bracket  
1x Table  
1x Mitre guide  
1x Fence

Attach both frame brackets to the sander using the cap-head bolts. Be aware that the table bracket pins should be pointing outwards once the brackets are fitted. As shown on page 13.



## ASSEMBLY INSTRUCTIONS...cont

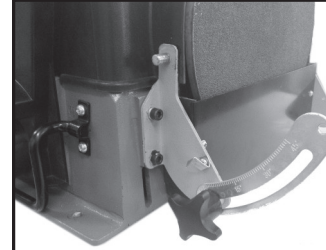

Locate the angle guide and knob and attach to one side of the sander; Repeat steps for the 2nd guide - Please note that one angle guide will be facing inwards).

Next slide the table bracket onto the frame bracket pin. Bolt the angle guide onto the table bracket. Repeat steps for the other side.

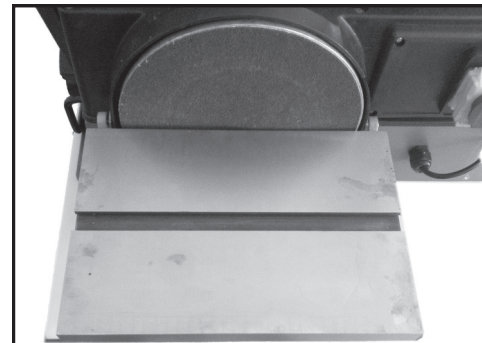

Fix table to table brackets using the 4 bolts supplied.

Slide mitre guide onto table as shown in picture.

